

**RECORD OF SURVEY
15 SAMPLE STREET, MALVERN
PART OF CROWN PORTION 71
PARISH OF PRAHRAN AT GARDINER
COUNTY OF BOURKE**

LAST PLAN REFERENCE: TP999999 (LOT 1)
ENCUMBRANCES - NIL
DATUM VIDE PS999999 & RE999999

NOTE:
THIS PLAN'S PRIMARY PURPOSE IS TO SHOW THE RELATIONSHIP BETWEEN OCCUPATION AND TITLE BOUNDARIES. POSSESSORY RIGHTS OF ABUTTING PROPERTIES SHOULD BE ASCERTAINED PRIOR TO DESIGNING AND/OR BUILDING OVER OCCUPIED BOUNDARIES. (REFER SECTIONS 8 AND 18 LIMITATIONS OF ACTIONS ACT 1958).
FENCE POSITIONS IN RELATION TO TITLE ARE NOT NECESSARILY DRAWN TO SCALE AND MAY HAVE BEEN EXAGGERATED FOR CLARITY.

FIRST AVENUE

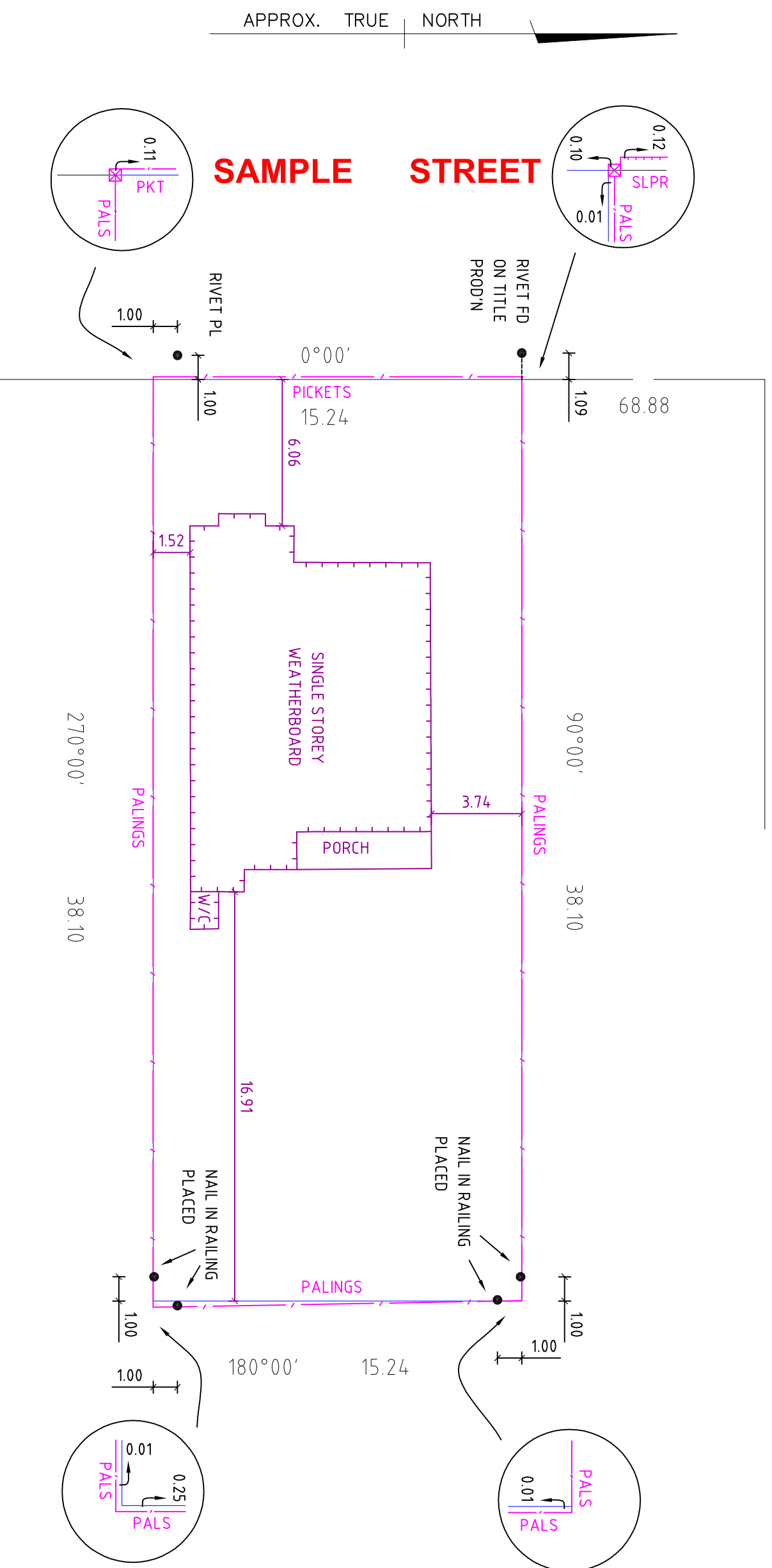

REF: 9999

ORIGINAL A3 SCALE 1:200

LICENSED SURVEYOR

**15-08-2018
DATE**

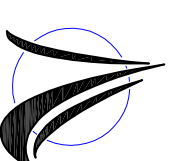

BRIAN WATSON SURVEYING

Office Address: 454 Waverley Road, EAST MALVERN, 3145
Mailing Address: PO Box 113, CARRNEGIE, 3163
Phone: 9572 3122 Fax: 9572 3144
Email: admin@brianwatsonsurveying.com.au ABN: 78 658 600 770